

PROJECT COURTESY:
811
 CALL BEFORE YOU DIG
 FOR STATE SPECIFIC DIRECT DIAL NUMBERS VISIT:
 WWW.CALL811.COM

REV	DATE	DRAWN BY	DESCRIPTION
1	04/20/15	JL/RSB	ISSUED FOR LAYOUT CHANGE, TYP. PLANNING LETTER, DATED 2/23/15
2	04/20/15	JL/RSB	ISSUED FOR CLIENT COMMENTS

REV	DATE	DRAWN BY	DESCRIPTION
1	04/20/15	JL/RSB	ISSUED FOR LAYOUT CHANGE, TYP. PLANNING LETTER, DATED 2/23/15
2	04/20/15	JL/RSB	ISSUED FOR CLIENT COMMENTS

C. RICHARD ROSEBERRY
 ENGINEER - LICENSE NUMBER 027794

PRELIMINARY AND FINAL MAJOR SITE PLAN FOR
KDC SOLAR
 SIX FLAGS GREAT ADVENTURE SOLAR

BLOCK 300, LOT 15 BLOCK 300,
 LOT 30 & PORTION OF LOT 11
 TOWNSHIP OF JACKSON
 OCEAN COUNTY
 NEW JERSEY

NAME/ADDRESS:
 KDC SOLAR
 100 American Metro Boulevard
 Hamilton, NJ 08613
 Phone: 609.587.5200
 Email: kdc.solar@kdcenergy.com

DATE: 03/23/15
SCALE: 1" = 50'
PROJECT: KDC SOLAR
CLIENT: KDC SOLAR

OVERALL PLAN
 3 of 29

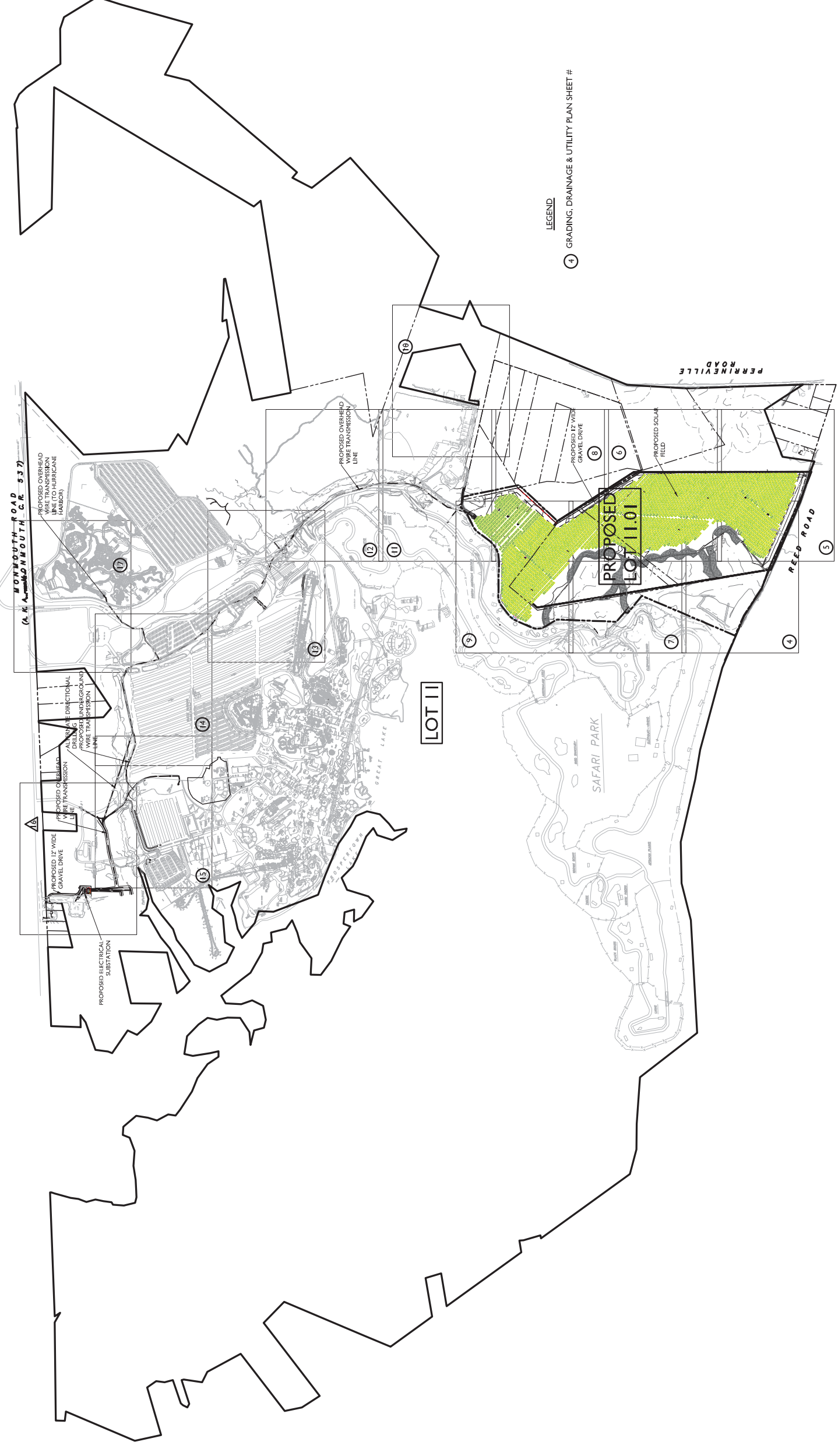
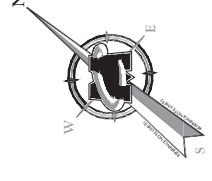

LEGEND
 ④ GRADING, DRAINAGE & UTILITY PLAN SHEET #

